



Interchangeable bases  
and lids create multiple  
size configurations  
**SEE NEXT PAGE**

**STRONGHOLD Cases from Gemstar** offer MIL-STD durability and airtight protection for high-value cargo. Featuring rotationally-molded double walls and thick corners STRONGHOLD is the choice for rugged, versatile and dependable protection.

**STRONGHOLD Standard Features**

- Rotationally molded, double-walled durability
- IP67 rated; watertight, airtight and dust-proof with automatic pressure relief valve
- Meets or exceeds MIL-STD 810F and meets military LLRC standards\*
- Recessed, heavy-duty black stainless steel hardware and spring-loaded bail handles
- Tongue & groove construction with gasket
- Interchangeable bases and lids in the series
- Interlocking, stackable design
- Non-water pooling design, even when inverted
- Choice of 10 standard colors
- Guaranteed Performance\*

\* See website for guarantee details, complete certifications and test procedures

**Dozens of Available Options**

- Custom foam inserts, foam material options and custom thermoformed inserts
- Shock mounts, hinged compartments and literature pockets
- Extension handles, edge casters and bottom caster wheels, including removable wheels
- Stenciling, graphics and metal or plastic engraved label plates
- Integrated padlock brackets
- Fire retardant resins available to meet V0 requirement of UL94 Flammability testing & MIL-STD-648 – Stacked Container Fire Test
- Case wall cutouts, build-to-plan configurations, custom testing and more

Contact your local Distributor or Sales Manager for more information, or visit **GemstarCases.com**



Gemstar Cases are proudly made in America.  
©2020 Gemstar Manufacturing

**SH3121-1504 top profile**

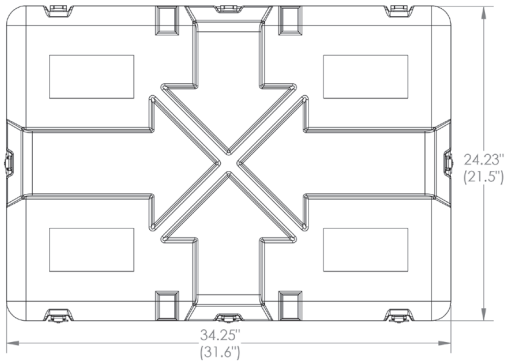

**MODEL NUMBER KEY**

**SH3121-XXXX**

Length ————  
Width ————  
Lid ————  
Base ————  
Model numbers refer to interior dimensions

**SH3121-1504 side and end profile**

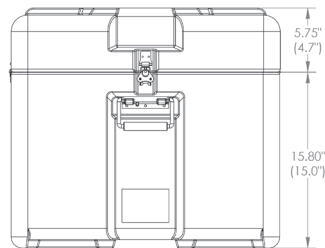
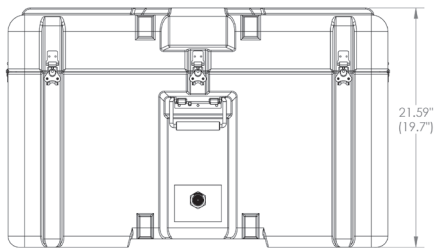

Nominal Interior Dimension	31.6"L x 21.5"W x 19.6"D
Base Depth	15.0"
Lid Depth	4.7" Hinged
Nominal Exterior Dimension	34.6"L x 24.6"W x 21.8"D
Approx. Weight	39.0 lbs.
Features	3 hinges, 5 latches, 4 handles

Contact your local Distributor or Sales Manager for more information, or visit [GemstarCases.com](http://GemstarCases.com)



Gemstar Cases are proudly made in America.  
©2020 Gemstar Manufacturing

## New Sizes Update

**GEMSTAR**  
CUSTOM HARD CASES

# STRONGHOLD<sup>®</sup>

## SH3121 Series Specifications

### SH3121-0415 top profile

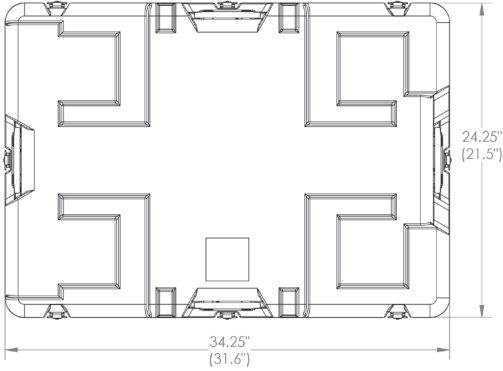

#### MODEL NUMBER KEY

**SH3121-XXXX**

Length  
Width  
Lid  
Base  
Model numbers refer to interior dimensions

### SH3121-0415 side and end profile

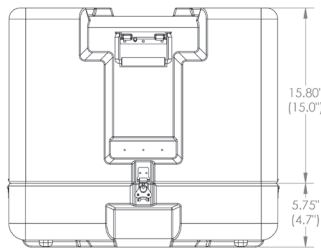
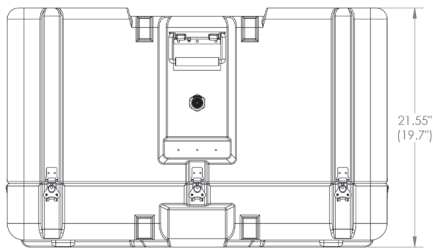

Nominal Interior Dimension	31.6"L x 21.5"W x 19.6"D
Base Depth	4.7"
Lid Depth	15.0" Removable
Nominal Exterior Dimension	34.6"L x 24.6"W x 21.8"D
Approx. Weight	39.0 lbs.
Features	8 latches, 4 handles

Contact your local Distributor or Sales Manager for more information, or visit [GemstarCases.com](http://GemstarCases.com)



Gemstar Cases are proudly made in America.  
©2020 Gemstar Manufacturing